

Filtro Cell

Deep Pleated Medium Filters



Key Features

- Low pressure drop
- Long service life
- Easy installation
- Deep pleated aluminium separator
- High quality glass fiber media
- Large filter surface area

■ UL Listed

- ▼ **Filter Standard** ASHRAE 52.2 / EN:779 / ISO 16890
- ▼ **Frame** GI / Wood / Aluminium
- ▼ **Header type** Single / Double / No header
- ▼ **Standard header size** 20-25mm
- ▼ **Media** Glass fiber
- ▼ **Separator** Aluminium
- ▼ **Sealant** PU

- ▼ **Efficiency** M6 to F9 / MERV11 to MERV15
- ▼ **Max. operating temperature** 100°C/212°F
- ▼ **Final Pressure Drop** 450 Pa / 1.8" WG
- ▼ **Gasket** Without (Available upon request)

Filtro Cell is a deep pleated box style filters with medium efficiencies. It is made from micro-fine fiberglass paper media and comes with metal frames. Filters are available in M6, F7,F8 and F9 efficiencies. Single, double and no header frame constructions are offered. Standard models come in 150mm and 292mm frame depth.

Construction

Filter Frames

The standard frame construction includes fire retardant Wood Particle Board, Galvanized steel (16,18 or 24gauge) and anodized aluminium. High temperature versions are constructed with Stainless steel frames

Filter Media Pack

Filtro Cell filters are manufactured from continuous length superior quality micro glass fiber paper media available in various efficiency grades. The filter media is moisture resistant and fire retardant. The pleated media is evenly and accurately positioned by corrugated aluminium separators having hemmed edges to add strength and to protect the media pack. The uniform and closed pleat filter pack provides a large surface area to hold the very fine dusts.

Sealant & Gaskets

The pleated media pack is encapsulated into the filter frame utilizing a two part high density fire retardant urethane elastomer. A flat profile neoprene gasket or a one-piece seamless urethane gasket is used to ensure a leak free seal to the filter housing. High temperature version is manufactured with ceramic sealant and temperature resistant gasket.

Filter Testing

The finished filters undergo a thorough quality checking .They are scan tested individually to ensure a leak proof performance and each filter possess the label showing the scan test result on it. We have testing facilities as per EN 779 Standard. Testing of filters can be done according to customer's request.

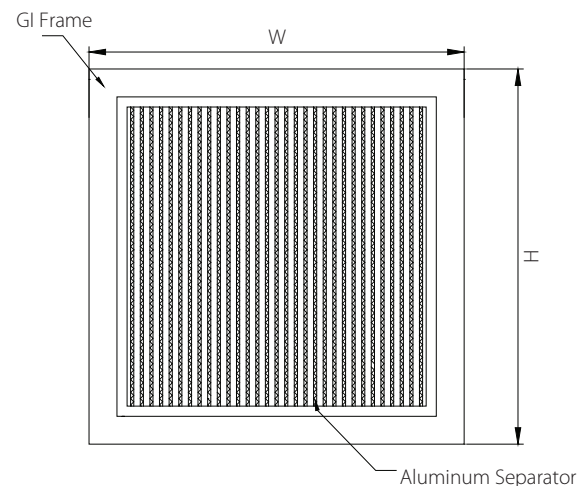
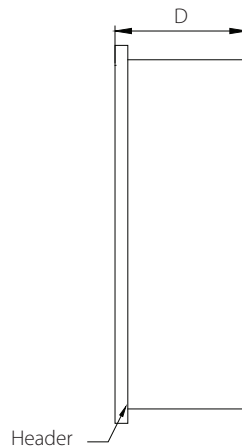
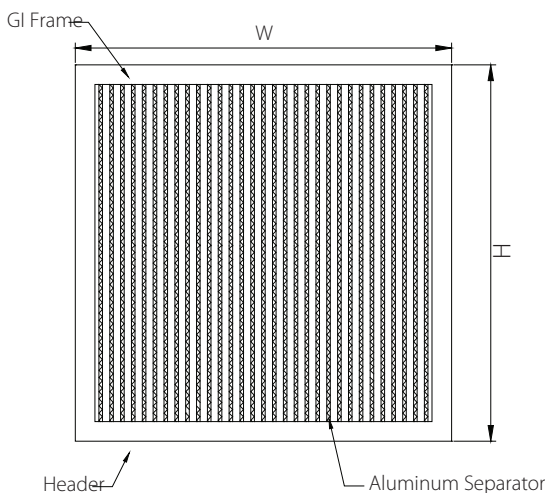



Filter Model	Nominal Size (in)	Actual Size		ASHRAE 52.2 / EN 779 : 2012	Rated Air Flow (CMH/CFM)	Initial Resistance (Pa / in.W.G)
		(mm)	(in)			
FCDP9-44-12	24X24X12	592X592X292	23.31X23.31X11.5	MERV 15/F9	3400/2000	155/0.66
FCDP9-24-12	12X24X12	287X592X292	11.5X23.31X11.5	MERV 15/F9	1700/1000	155/0.66
FCDP9-44-6	24X24X6	592X592X150	23.31X23.31X5.9	MERV 15/F9	1700/1000	155/0.66
FCDP8-44-12	24X24X12	592X592X292	23.31X23.31X11.5	MERV 14/F8	3400/2000	136/0.54
FCDP8-24-12	12X24X12	287X592X292	11.5X23.31X11.5	MERV 14/F8	1700/1000	136/0.54
FCDP8-44-6	24X24X6	592X592X150	23.31X23.31X5.9	MERV 14/F8	1700/1000	136/0.54
FCDP7-44-12	24X24X12	592X592X292	23.31X23.31X11.5	MERV 13/F7	3400/2000	110/0.44
FCDP7-24-12	12X24X12	287X592X292	11.5X23.31X11.5	MERV 13/F7	1700/1000	110/0.44
FCDP7-44-6	24X24X6	592X592X150	23.31X23.31X5.9	MERV 13/F7	1700/1000	110/0.44
FCDP6-44-12	24X24X12	592X592X292	23.31X23.31X11.5	MERV 11/M6	3400/2000	80/0.32
FCDP6-24-12	12X24X12	287X592X292	11.5X23.31X11.5	MERV 11/M6	1700/1000	80/0.32
FCDP6-44-6	24X24X6	592X592X150	23.31X23.31X5.9	MERV 11/M6	1700/1000	80/0.32

Airflow vs Initial Resistance

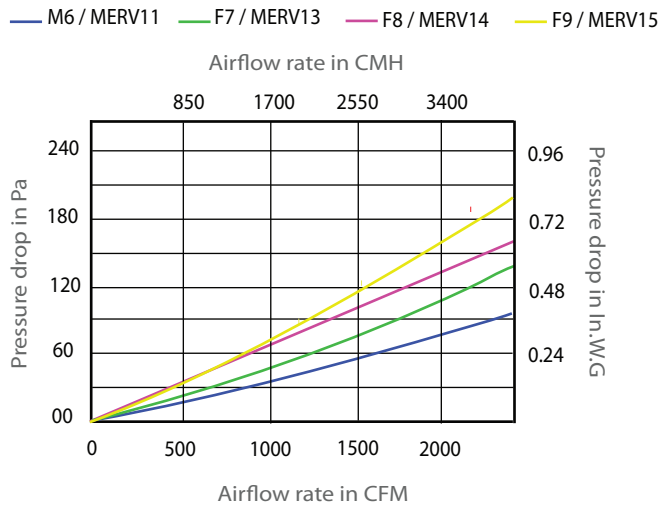

Model Details Breakdown

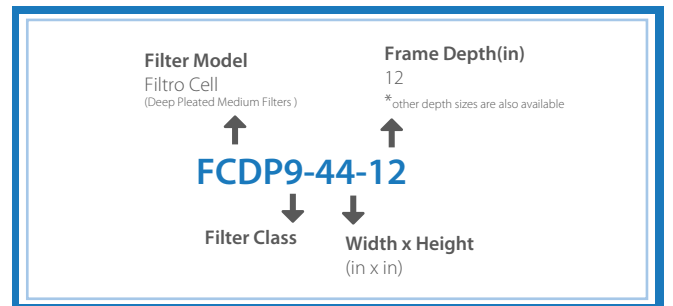

Frame	GI / Aluminium / Wood
Media	Glass fiber
Separator	Aluminium
Sealant	Polyurethane
Rec temp	100°C / 212°F
Efficiency standard	ASHRAE 52.2 / EN : 779 / ISO16890
Nominal air flow	3400 CMH / 2000CFM
Final pressure drop	450 Pa / 1.8" WG
Gasket	Up on request

Available upon request

- HT Models (Filtro Cell HT)
- Mesh support upstream & downstream
- Bar support

Our Group Companies and Global Network

